

SD 71

Flour Detacher

Machine for the breaking up of flour particles under the roller mills. Cylindrical shape, steel sheet structure with bladed bars rotor.

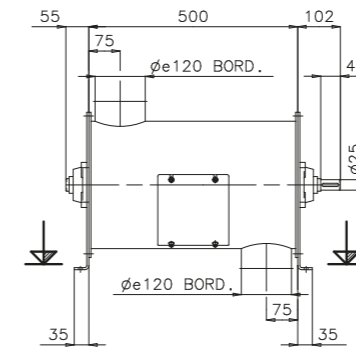

VERSION WITH ROUNDED PULLEY FOR FLAT BELT

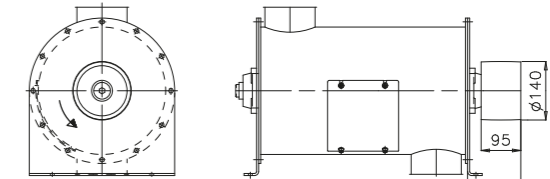

ROTATIONS/MIN SPINDLE SHAFT FOR REFINERS=650
ROTATIONS/MIN SPINDLE SHAFT FOR REMILLING=1250

VERSION WITH BUILT IN MOTOR

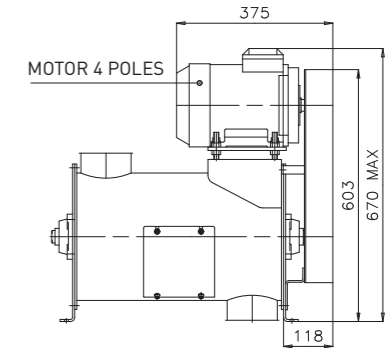

Type	Kw	Hz
SD/71-1,5	1,5	50
SD/71-2,2	2,2	50
SD/71-3	3	50
SD/71-1,5	1,5	60
SD/71-2,2	2,2	60
SD/71-3	3	60

Units = mm