

Technical Specification Sheet

Swing Arm Fork Lift Boom [LAH200]

This versatile fork lift attachment has five locking points set at 15 degree increments to conveniently slew a load, avoiding the need to reposition a fork lift or telehandler whilst on site.

The swing arm is extendable from 1520mm to 2500mm which varies the lifting capacity. Team with GGR's vacuum lifters for effortless glass and cladding installation work. Suitable fork lifts with a 2500kg work load limit.

Features

- Capacity: 500-1200kg depending on angle and boom length
- Dimensions (mm): 1650 (l) x 930 (w) x 390 (h)
- Boom slews 30° left and right
- Weight: 120kg
- Vacuum lifter hired / sold separately.

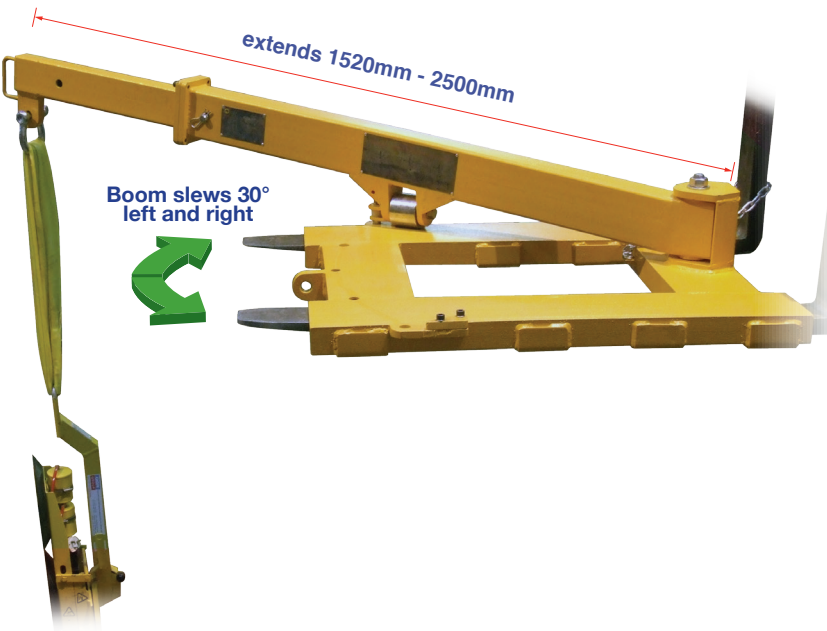

Technical Specification

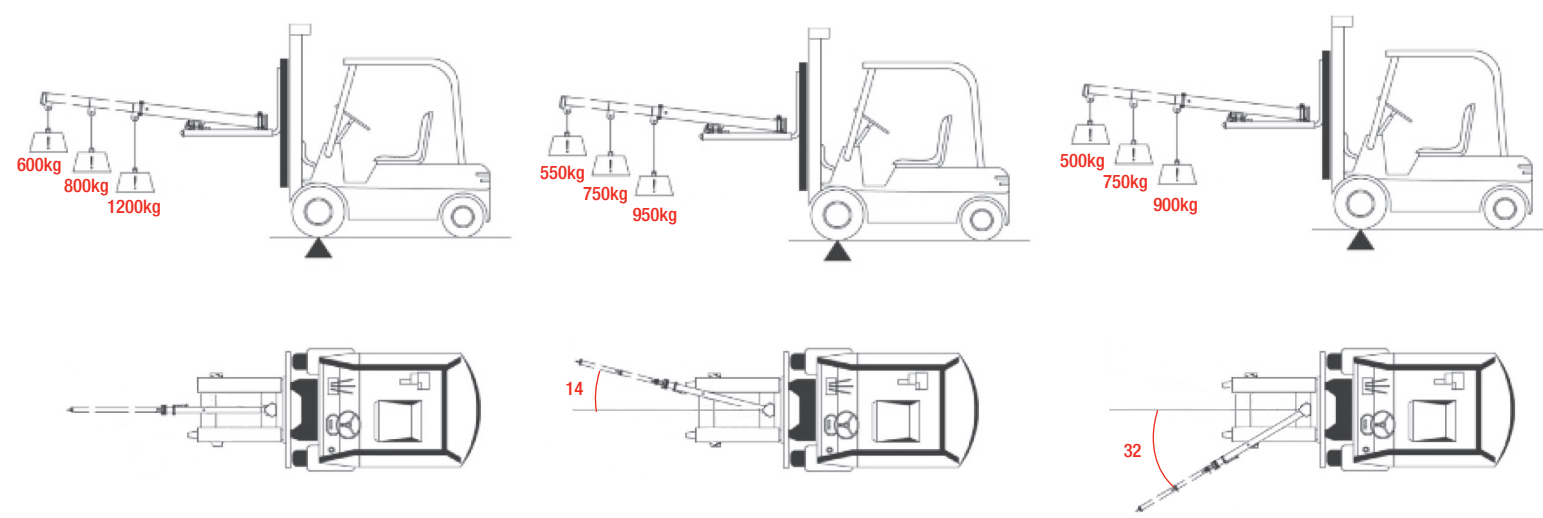

HIRE OR PURCHASE TODAY - CALL OUR SPECIALIST TEAM ON:

North: +44 (0)161 683 2580 - South: +44 (0)1844 202 071 - Scotland: +44 (0)1698 824 444

www.ggrgroup.com