

A Must-Have For Glazing

Geko 350 PV [350kg]

The Geko 350 PV is the big brother of our popular Geko 250 PV robot and boasts 350kg of lifting power for effortless installation of unitized glazing units and window elements.

A must-have machine for glazing and fenestration contractors, the Geko 350 PV precisely manipulates glazing panels, curtain walling and window units into position. The dual circuit vacuum head rotates 180° left and right, tilts forward 30° and back 20° and also features 500mm of powered vertical movement.

A great device for interior or exterior glazing work, the Geko 350 PV can fit through a standard doorway thanks to its adjustable wheel width and removable counterweights. This pedestrian controlled robot is easy to operate, comes with a digital vacuum gauge, pendant remote control suction release, 100mm rods and optional 300mm extension rods for handling windows with deeper mullions.

Geko 350 PV+ [175kg]

The Geko 350 PV+ has a horizontal lifting arm capable of picking up 175kg from ground level and lifting to a height of 1.8m. Loads can be tilted 180° and installed overhead to a maximum height of 3m.

The Electric PV and PV+ versions of these machines include powerful 12v batteries with 20% more capacity to aid driving operation.



Technical Specifications

Geko 350 PV Geko 350 PV+

		Geko 350 PV	Geko 350 PV+
Safe working load	capacity:	350kg	175kg
Suitable for lifting	material properties: surface: example:	gastight / non-porous smooth glass, plastic boards, ceramic plates	
Weight	with counterweights: without counterweights:	600kg 350kg	635kg 385kg
Maximum/minimum width	width:	820mm (618mm)	820mm (618mm)
Travelling length	length:	2070mm	3100mm
Travelling height	height:	1265mm	1265mm
Number of suction cups	cups:	4	4
Powered vertical head movement	vertical movement:	500mm	500mm
Powered head tilt	powered head tilt:	30° forward and 20° backwards	180°
Manual head sideshift	manual head sideshift:	120mm	120mm
Manual pad frame rotation	rotation:	180° left & right	180° left & right
Manual head slew	manual head slew:	90° left & right	n/a
Vacuum system	dual circuit:	1 pump, 2 vacuum reserve tanks	1 pump, 2 vacuum reserve tanks
Power requirements	rechargeable battery: pump:	110v/240v charger 12v DC	110v/240v charger 12v DC

Geko 350 PV Electric Geko 350 PV+ Electric

	Geko 350 PV Electric	Geko 350 PV+ Electric
	350kg	175kg
	gastight / non-porous smooth glass, plastic boards, ceramic plates	
	670kg 420kg	705kg 455kg
	848mm	848mm
	2170mm	3200mm
	1255mm	1255mm
	4	4
	500mm	500mm
	30° forward and 20° backwards	180°
	120mm	120mm
	180° left & right	180° left & right
	90° left & right	n/a
	1 pump, 2 vacuum reserve tanks	1 pump, 2 vacuum reserve tanks
	110v/240v charger 12v DC	110v/240v charger 12v DC



Extension rods 100mm and 300mm

Optional horizontal extension arm

Optional vertical extension arm

Hydraulic horizontal lifting arm pick-up

Offroad double tyres available

Optional puncture proof tyres



PV Electric

Electric option available for both the Geko 350 PV & PV+.



Optional curved glass pads available. Capacity 350/175kg.



PV+

The Geko PV+ arm allows panels weighing up to 175kg to be picked up and tilted 180° for overhead and ceiling installation up to 3m high.



180° manual pad frame rotation left & right

30° forwards and 20° backwards powered head tilt (PV) or 180° (PV+)

500mm powered vertical head movement



90° manual head slew left & right

120mm manual head sideshift

Hydraulic arm up & down

Reference Codes

- Geko 350 PV **GRG07**
- Geko 350 PV+ **GRG09**
- Geko 350 Electric PV **GRG11**
- Geko 350 Electric PV+ **GRG12**

Technical Data - 350 PV (mm)

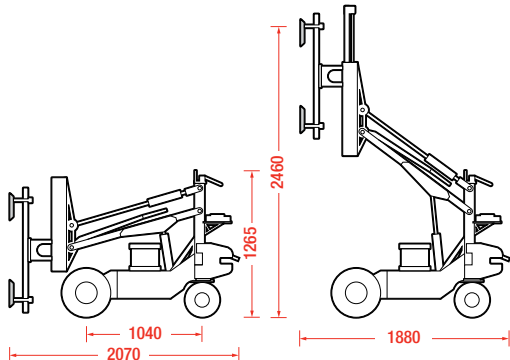

Technical Data - Pad Frame (mm)

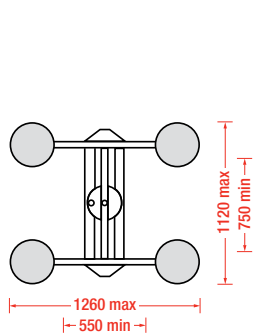

Technical Data - 350 PV+ (mm)

