

R135-Series

Rotary Switches

The R135 and R135A-Series rotary switches are single pole, single throw "L" rated up to 3A, feature an ON-OFF repeating action, and are available with a nylon actuating knob; nylon snap-in bracket or nickel-plated brass bushing. These switches are typically used to control lighting functions.



Carling Technologies®

Innovative Designs. Powerful Solutions.

Innovative Designs. Powerful Solutions.

Carling Technologies, Inc.
60 Johnson Avenue • Plainville, CT 06062-1177
Phone: (860) 793-9281 • Fax: (860) 793-9231
Email: sales@carlingtech.com • www.carlingtech.com

Dielectric Strength

UL/CSA: 1000V - live to dead metal parts

Electrical Life

100,000 cycles

Mechanical Life

100,000 cycles

Operating Temperature

32°F to 185°F (0°C to 85°C)

R135-A - BL

¹
Base Part Number

²
Knob Color

1 BASE PART NUMBER: SERIES/CIRCUITRY/RATING/TERMINATION

1.5A 250 VAC; 3A 125 VAC L; 5A 12 VDC
 OFF-ON repeating .375 threaded bushing **R135**
 OFF-ON repeating nylon snap-in bezel **R135-A**

Wire Leads

2 KNOB COLOR¹

BL Black
WH White

Notes:
 Standard Wire Leads are 6" long, stripped 1/2" black. If different length required, please specify at the end of the part number. ex. R135-A-BL/20". Panel Cut-Out Recommendations: For sheet metal panels, switch must enter panel in same direction as the punch. Burr on bottom. Test cut hole in actual material.

¹ Custom colors available. Consult factory.

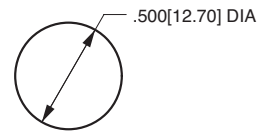
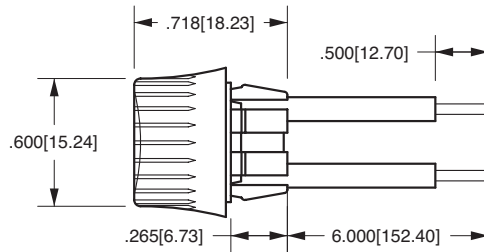
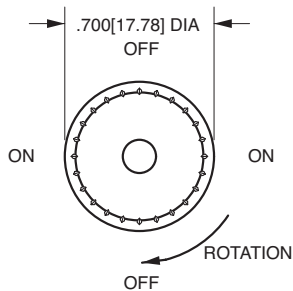

NYLON BEZEL MOUNTING HOLE
 Snaps into .500[12.70] Dia. hole
 Panel Thickness: .020[.508] to .078[1.98]

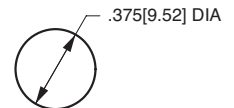

THREADED BUSHING MOUNTING HOLE
 Fits into .375[9.52] Dia. hole
 Bushing Length: .312[7.92]

*Manufacturer reserves the right to change product specification without prior notice.