

FACTSHEET - MPS - 296

Characteristics 20 ft x 9.6 ft container pontoon

Length O.A.	6.09 m (20ft)
Breadth O.A.	2.44 m (8ft)
Depth	2.89 m (9.6ft)
Weight	8.8 ton
Deck thickness	10 mm
Watertight bulkhead 1	
Compartments 2	
Manholes 2	
Deckload 8.0 t/m ²	
T (draught) empty 0.59 m	
T (draught) Max. 2.46 m	
Load cap at t Max. 28.0 ton	
Class society Bureau Veritas	
Class Notation Inland waters	
Sheltered area	
Coastal area	

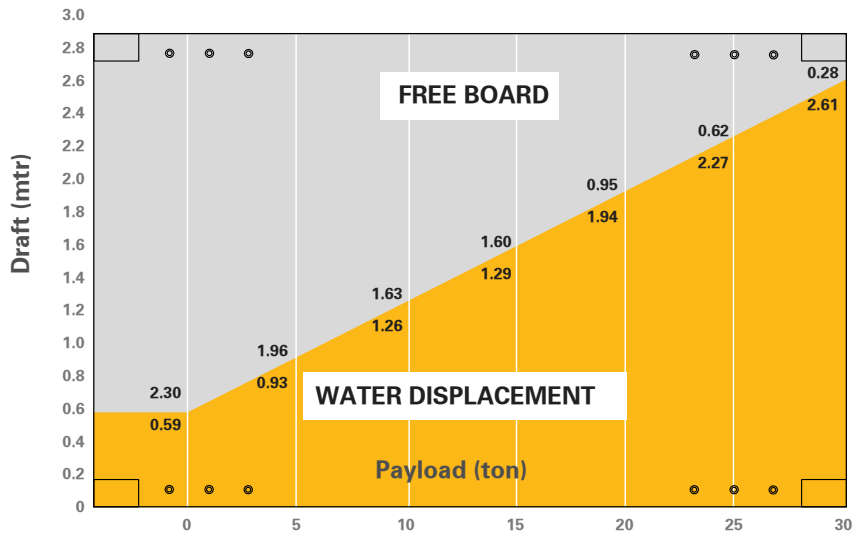

TEKLOCK®

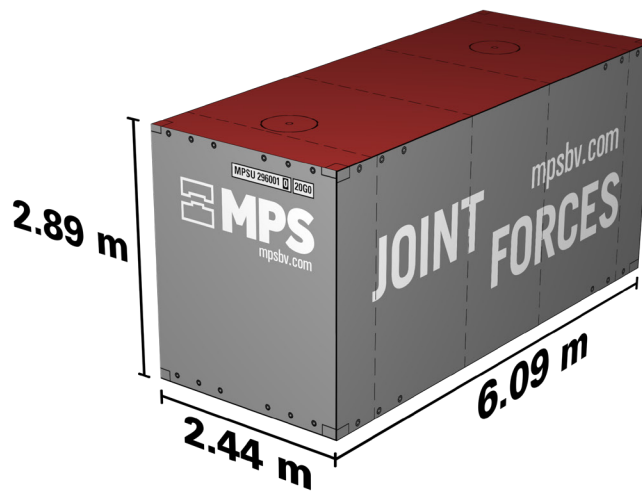
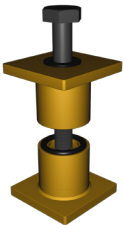

TRANSPORT OPTIONS



BY ROAD



BY SEA



BY RAIL

MPSU 296001 0 20G0

CSC APPROVAL
 CERTIFICATE

CSC SAFETY APPROVAL			
APPROVAL REFERENCE			
DATE MANUFACTURED			
IDENTIFICATION No.			
MAXIMUM OPERATING GROSS MASS	kg		lbs
ALLOWABLE STACKING LOAD FOR 1.8 g	kg		lbs
TRANSVERSE RACKING TEST FORCE	newtons		
END WALL STRENGTH	kg	NIL	lbs
SIDE WALL STRENGTH	kg	NIL	lbs
NEXT EXAMINATION DATE			