



# FLUID TRANSFER SYSTEMS

## SS wire braided Gas hose

### Product Description

Slowly sintering PTFE allows the crystalline structure to become tighter reducing the voids within the wall. This means you get a hose that is ideal for gas delivery applications due to lower permeation.

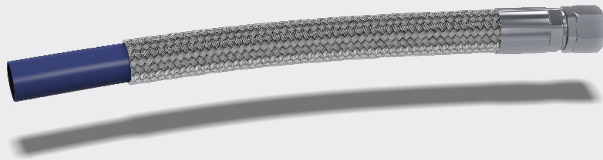

### Properties

Application	Low pressure gas delivery applications
Design	Medium pressure smoothbore PTFE tube with a double braid high tensile 304 stainless steel.
Inner Layer	Gas quality smoothbore PTFE tube
Outer Layer	High tensile 304 maypole wound Stainless Steel braid
Temperature Min / Max	-60°C to +260°C (-76°F to +500°F)
Material	PTFE according to "ISO12086, Part 1.PTFE-E.P.D.M 1.6.1.C.E.4_12"
Other	

### Gas Hose 1 Wire Braid Range

USA Part Number	Part Number	Description	Braided ID Nominal		Tolerance		Braided OD Nominal		Tolerance		Tube Wall Thickness Nom.		Max. Working Pressure		Min. Burst Pressure		Min Bend Radius	
			(mm)	(in)	(mm)	(in)	(mm)	(in)	(mm)	(in)	(psi)	(bar)	(psi)	(bar)	(mm)	(in)		
TSGV3.5B01	TSGV3.5B01	1/8" GAS	3.5	0.138	0.3	0.012	6.43	0.253	0.4	0.016	1.02	0.04	3,375	233	13,500	931	38	1.496
TSGV4.9B01	TSGV4.9B01	3/16" GAS	4.93	0.194	0.4	0.016	8	0.315	0.6	0.024	1.02	0.04	3,000	207	12,000	828	51	2.008
TSGV6.6B01	TSGV6.6B01	1/4" GAS	6.6	0.26	0.4	0.016	10.16	0.4	0.6	0.024	1.02	0.04	2,750	190	11,000	759	64	2.52
TSGV8.1B01	TSGV8.1B01	5/16" GAS	8.05	0.317	0.4	0.016	11.48	0.452	0.6	0.024	1.02	0.04	2,700	186	10,800	745	76	2.992
TSGV9.2B01	TSGV9.2B01	3/8" GAS	9.2	0.362	0.4	0.016	12.75	0.502	0.6	0.024	1.02	0.04	2,250	155	9,000	621	89	3.504
TSGV10.3B01	TSGV10.3B01	13/32" GAS	10.3	0.406	0.4	0.016	13.95	0.549	0.6	0.024	1.02	0.04	2,100	145	8,400	579	102	4.016