

This rotator having stood the test for many years distinguishes for exact, sensitive and very sturdy rotations. Its low dead weight contributes, moreover, to universal usefulness thus increasing the performance of any ancillary equipment

- safe connection by long fastening screws
- high admissible axial forces
- wide passage for oil
- high torque
- long life
- low structure

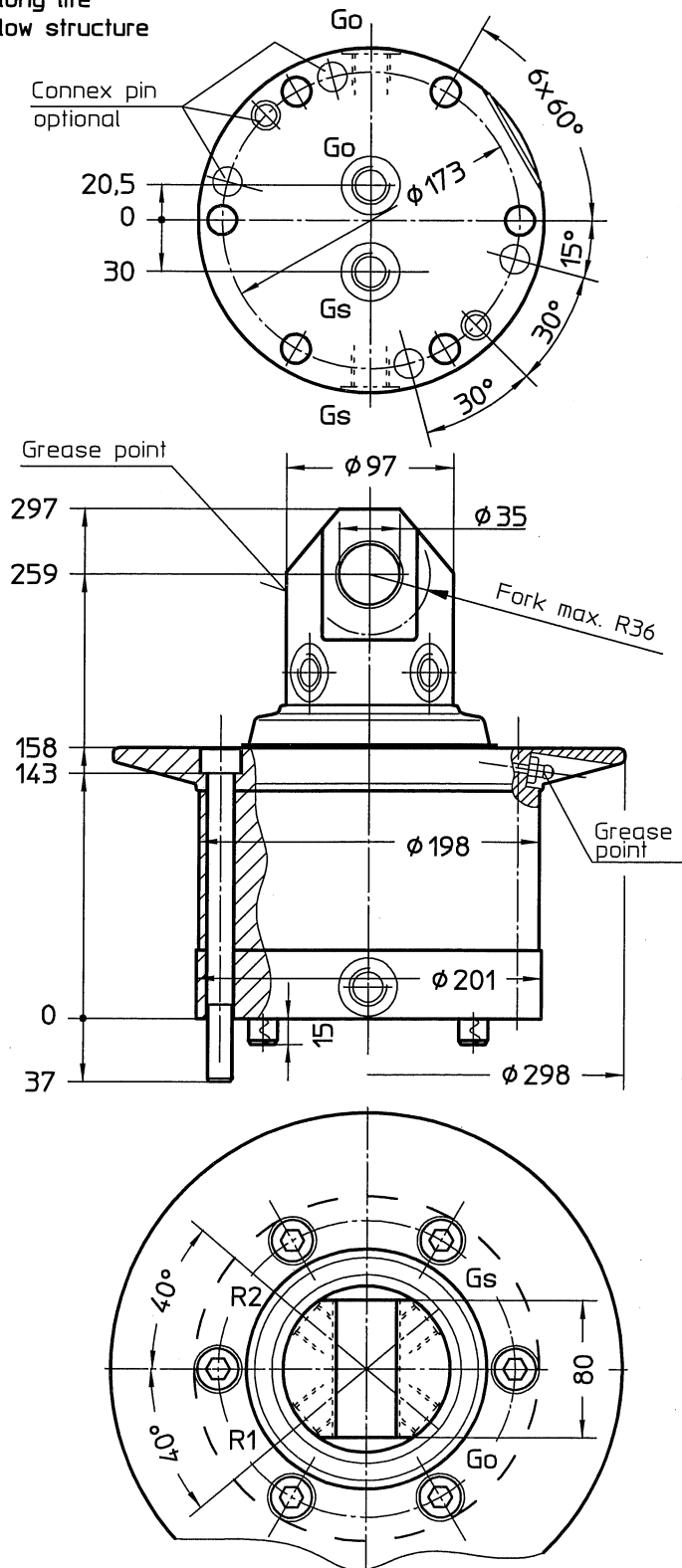

Standard design:

to be fastened by 6 cap screws M16 DIN912
 hole circle ϕ 173 to Thumm shop standard
 with 2 radial and 2 axial connections

Machine:

e.g. hydraulic excavators service weight:
 with cardanic mounting max. 12ts
 truck-handling and loading cranes,
 jerk pullers, forestry machines

Add-on units:

logging tongs, loading grabs,
 clamshell buckets,
 Sorting units (please ask manufacturer)

Technical details:

max. thrust load	= 60KN
max. radial load	by request
Pmax. grab	= 350bar
Pmax. rotating engine	= 200bar
Torque/100bar	= 600Nm
Absorption volume	= 500cm ³ /R
min. oil passage Gs/Go	= NW10
Mass	= 42kg
max. rotations	= 30rpm



Accessories:

forks for suspension
 (please refer to separate dimensioned sheets)

Volume of delivery:

2x Connex pin SG 16x30
 1 set cap screws M16x180-10.9 DIN 912
 with self-securing nuts M16 DIN 985

Connections:

R1,R2: turn rotator		G 1/2"
Go: open grab		G 1/2"
Gs: close grab		G 1/2"

Edition 102 Gm.

Paint: black primary coat
 Reserve made to modifications
 All rights reserved