

E 6050

HGT30

DIAPHRAGM WALL KIT

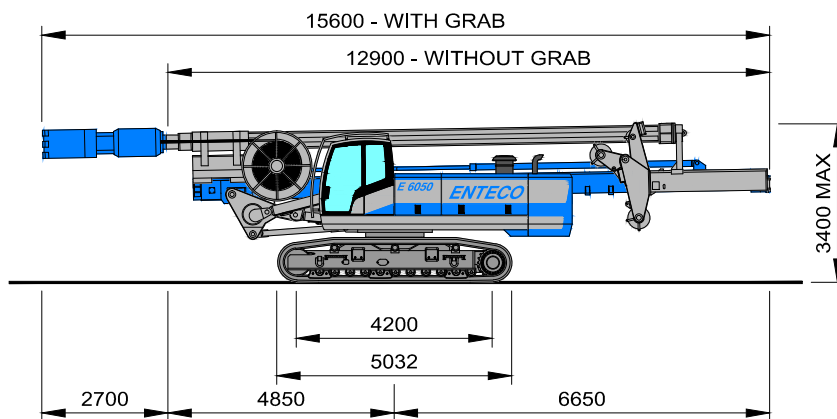
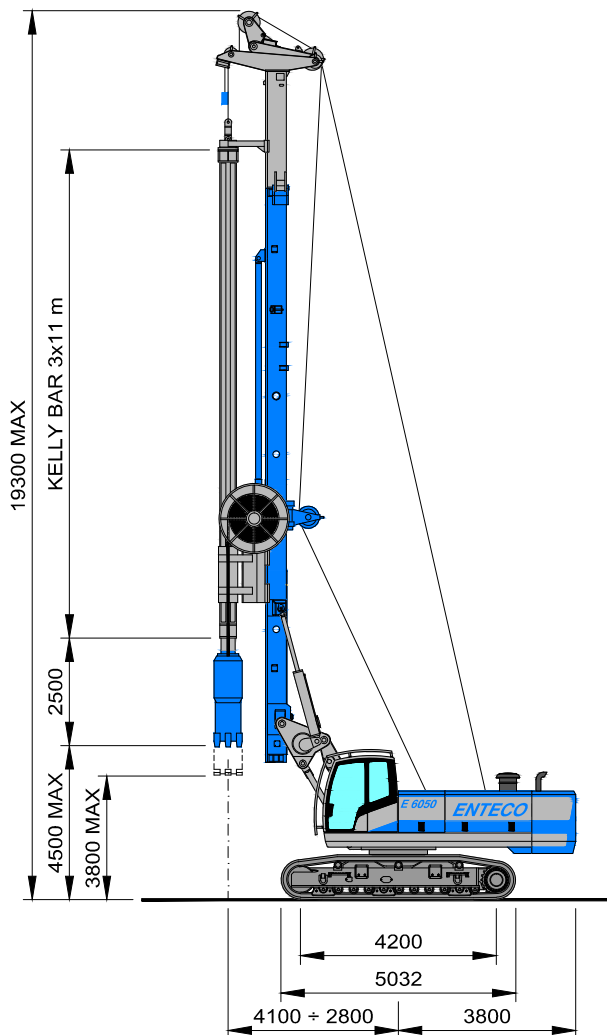

E 6050 - HGT30 DIAPHRAGM WALL KIT

OPERATING WEIGHT	ton	up to 56
Max depth	m	30

HYDRAULIC GRAB

Model	ENTEKO HG3	
Width of trench	mm	300+1200
Length of trench	mm	2000-2500

TELESCOPIC KELLY

Type - elements/length	3x11	
Max depth	m	30
Interlocking 1st element	option	
Kelly rotation	±45°	

E 6050 - BASE MACHINE

CRAWLERS

		STANDARD	OPTION
Overall width	mm	3000+4200	2550+3950
Track pads	mm	700	650
Crawler drive speed	km/h	2.1	2.1

DIESEL ENGINE

Model	CATERPILLAR	C9 ACERT
Rated power	HP/kW	350/261
Fuel tank capacity	litres	400

MAIN WINCH

Max line-pull 1st layer	kN	165
Free-fall device	installed	

AUXILIARY WINCH

		STANDARD	OPTION
Max line-pull 1st layer	kN	50	70
Free-fall device		option	option



Via dell'Artigianato, 33 - Z.I. - 30020 Fossalta di Piave - VENEZIA - ITALIA
 Tel +39 0421 67.99.77 - Fax +39 0421 67.99.93 - e-mail: info@entecodrill.com - www.entecodrill.com