

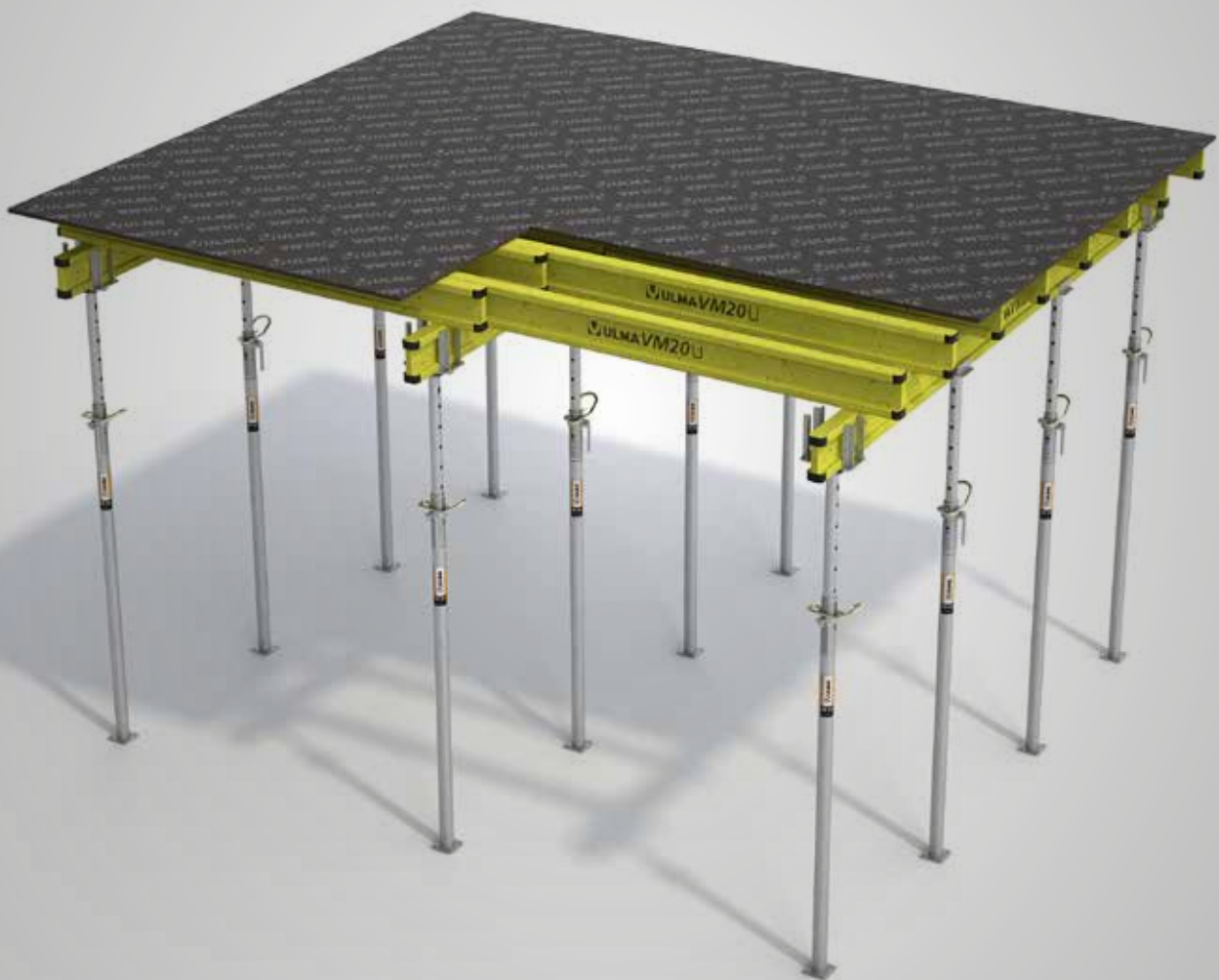

# ENKOFLEX

TIMBER BEAM SLAB FORMWORK

Flexible and versatile





## Features

- **System adaptable** to any type of slab and height. Independent beams provide **great flexibility**.
- Moldable to **irregular geometries** and to other formwork systems for easy infilling.



A large range of high-performance slabs

## System components

- 1 VM-20 primary beams
- 2 VM-20 secondary beams
- 3 Double head
- 4 Single head VR
- 5 Safety handrail
- 6 Prop
- 7 Tripod
- 8 Board

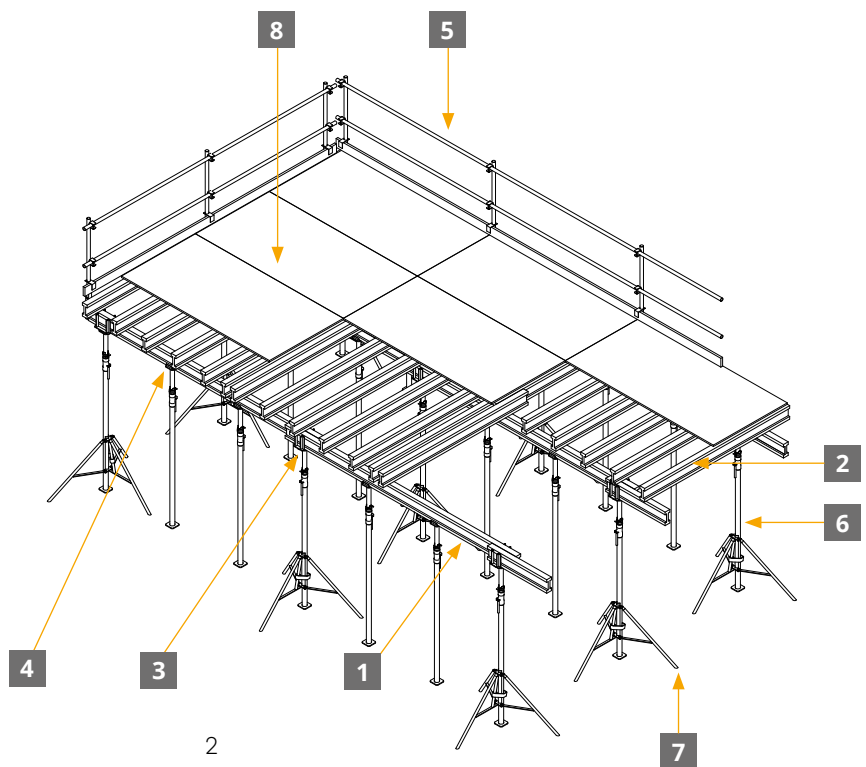





Very similar to formwork

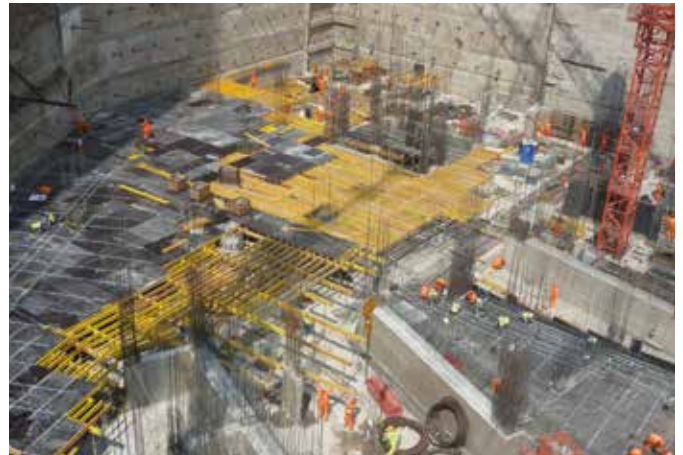

Surface formwork with interferences



Adaptable to all types of geometries

## Advantages

### Certified components

- Timber beam VM-20
  - **Certified in accordance with European standard EN 13377** for prefabricated wooden beams for formwork.
- **PEFC** : Chain of custody.
- Three-layer plywood
  - **PEFC** : Chain of custody.
- Phenolic plywood
  - **FSC®**: The material used for this component has been responsibly sourced.



High quality timber beam, main component of the system

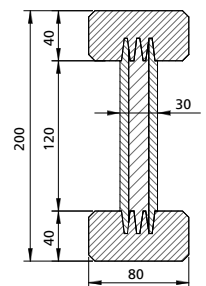

Beam Sizes (mm)

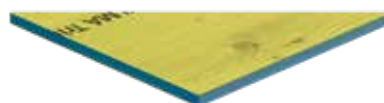



### All-round solution

- **Very versatile** for different slabs and heights based on the beams grid and shoring used.
- Option to **shore with prop or falsework**, depending on the height.
- **Simple and easy to assemble.**
- **Small number of items:** wooden beams, heads, board and shoring.
- **Compatibility** with other ULMA formwork systems.



*Inclined surface with ENKOFLEX on the falsework*



*Laying slabs with an irregular geometry*



*Easy laying between walls with ENKOFLEX*

- Amount of material adaptable to the thickness of the slab.
- Complies with the most demanding concrete **finishing requirements** as you can choose the board for any circumstance.
- **Durability** of the beams: edges protected with a covering for knocks and damp.





# Solutions

## / Shoring with prop



Shoring with certified EP steel prop



Shoring with SP prop

## / Shoring with falsework



Shoring of large loads with ALUPROP towers



Formwork assembly platforms on falsework tower



Shoring at a height with T-60 falsework



Stable shoring with BRIO falsework



Shoring on a building construction with G falsework





/ Technical solutions

**Drop beam**



*Construction of intermediate and perimeter drop beams*



*Wooden beams at different levels*

**Infilling on wall**



*Formwork against a single wall*

**Infilling on column**



*Stable support of the board on infillings on column*

**Curved slabs**



*Laying curved slabs with falsework at different heights*







# Basic components



Slabs laid with vertical ENKOFLEX with steel props, aluminium towers and falsework

TIMBER BEAMS	Code	Weight (kg)
Timber beam VM 20/1.45	1940191	8
Timber beam VM 20/1.9	1940172	9.5
Timber beam VM 20/2.15	1940197	10.8
Timber beam VM 20/2.45	1950129	12.3
Timber beam VM 20/2.65	1940196	13.3
Timber beam VM 20/2.9	1940144	14.5
Timber beam VM 20/3.3	1950130	16.5
Timber beam VM 20/3.6	1940146	18
Timber beam VM 20/3.9	1950112	19.5
Timber beam VM 20/4.5	1940178	22.5
Timber beam VM 20/4.9	1950113	24.5
Timber beam VM 20/5.9	1940149	29.5

HEADS	Code	Weight (kg)
Double head VR	2211003	4.9
ECO double head	2211450	2.4
Simple head VR	2211000	0.73

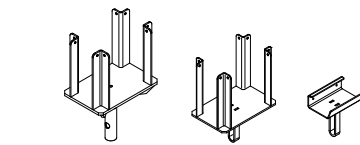

Tripod 42-87 mm 2170355 7

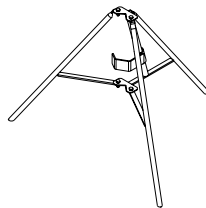

MISCELLANEOUS AND AUXILIAR	Code	Weight (kg)
Chain VR 7.5 kN	2211750	9.8



Clamp SP-EP 2170356 1.6

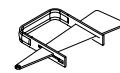

MISCELLANEOUS AND AUXILIAR	Code	Weight (kg)
Stop-end corner	2170358	1.1



Cross prop SP-30 2170365 3.7

Cross prop SP 35-40 2170360 3.7

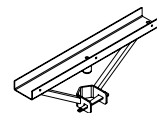

Clamp VM-VM 2211250 0.72



SAFETY ITEMS

VM handrail support 2211165 6.9

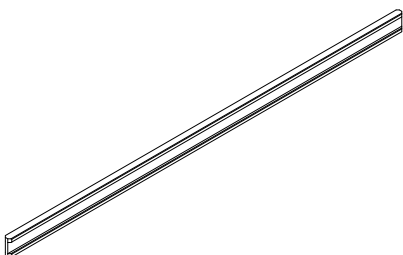
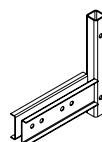



It's **all** about **trust**

---

[www.ulmaconstruction.com](http://www.ulmaconstruction.com)

**ULMA C y E, S. Coop.**  
Ps. Otadui, 3 - P.O. 13  
20560 Oñati, Spain  
T. +34 943 034 900  
F. +34 943 034 920



**IMPORTANT:**

Any safety provisions as directed by the appropriate governing agencies must be observed when using our products. The pictures in this document are snapshots of situations at different stages of assembly, and therefore are not complete images. For the purpose of safety, they should not be deemed as definitive. All of the indications regarding safety and operations contained in this document, and the data on stress and loads should be respected. ULMA's Technical Department must be consulted anytime that field changes alter our equipment installation drawings. The loads featured in this document, related to the basic elements of the product, are approximate. Our equipment is designed to work with accessories and elements made by our company only. Combining such equipment with other systems is not only dangerous but also voids any or all our warranties. The company reserves the right to introduce any modifications deemed necessary for the technical development of the product. All rights reserved. Neither all nor part of this document may be reproduced or transmitted in any way by any electronic or mechanical procedure, including photocopy, magnetic recording or any other form of information storage or retrieval system without the written permission.  
© Copyright by ULMA C y E, S. Coop

05H123ENM