

TOWEL RAIL INSTALLATION INSTRUCTIONS

Important Information

Installation should be carried out by a qualified professional or other fully competent person and should be installed in accordance with the relevant British and European Standards (BS5449:1990, BS7593:1992, EN12828:2003 & EN12831:2003)

PLEASE ENSURE THAT YOU WEAR ALL NECESSARY PERSONAL PROTECTIVE EQUIPMENT FOR YOUR SAFETY.

Please check that all components are present and that you are ENTIRELY happy with the size, design and finish BEFORE starting installation.

THIS TOWEL WARMER HAS BEEN PRE-FILLED AND ADJUSTED FOR ELECTRICAL STAND ALONE USE. NO FILLING IS REQUIRED; DO NOT REMOVE ANY OF THE SEALS AS THIS MIGHT CAUSE LEAKAGES AND VOID THE WARRANTY.

Pack Contents

1 x Electric Towel Warmer
4 x Bracket Base
4 x Bracket Stem

4 x Bracket Front
4 x Bracket Cover
4 x Wall Plug

4 x Wall Screw
4 x Washer
4 x Bracket Screw
4 x Mini Screws

FITTING THE TOWEL RAIL ON TO THE WALL

STEP 1

Select your desired mounting position and check that the wall is sufficiently strong enough to hold the weight of the towel warmer filled with water. Mark your preferred bracket positions on the wall and drill holes as necessary for the fixings that you are using. The Wall Plugs supplied are only suitable for solid walls.

Please note: If the wall is other than a solid construction other means of fixings will be required.

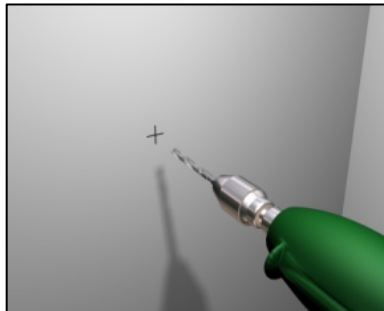

STEP 1.

STEP 2.

Screw the Bracket Base to the wall using the Wall Screws and Washers provided.

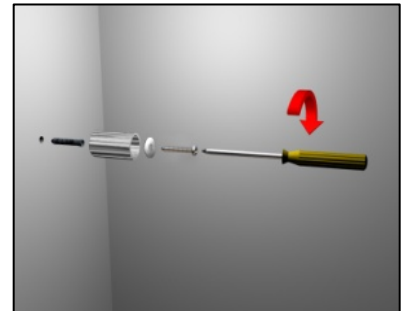

STEP 2.

STEP 3.

Loosely fit the Bracket Stems to the towel warmer with the Bracket Fronts and Bracket Screws.

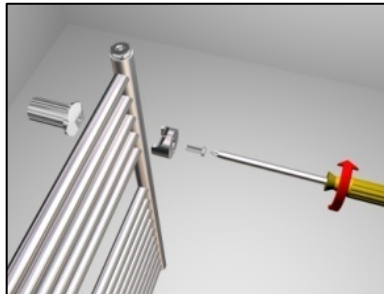

STEP 3.

STEP 4.

Align the Bracket Stems with the Bracket Bases and push the towel warmer back into position.

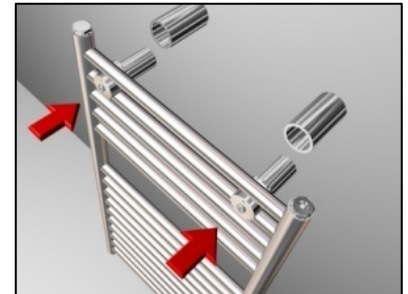

STEP 4.

STEP 5.

Tighten the Bracket Screws with a screwdriver.

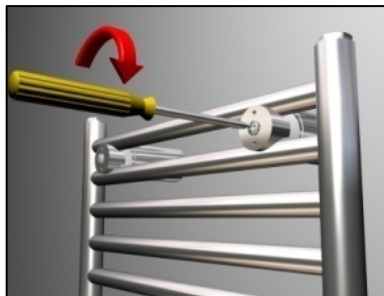

STEP 5.

STEP 6.

Insert the Mini Screws into the Bracket Bases and tighten with a screwdriver to lock bracket into position.

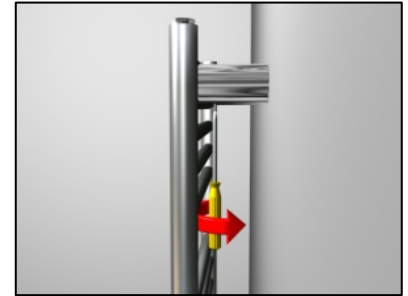

STEP 6.

STEP 7.

Push the Cover Caps into position on the Bracket Fronts.

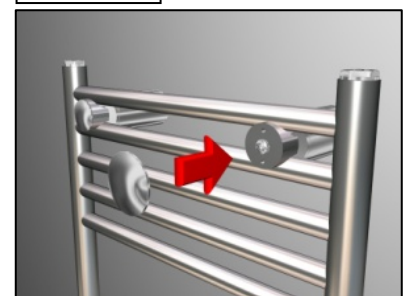

STEP 7.

CONNECTING THE TOWEL RAIL

Always switch off the electricity supply at the mains during installation.

The power supply to the towel rail must be protected, in accordance with applicable standards, by a 30mA differential circuit-breaker, 16A rated. Before carrying out any connection tasks, cut off the power supply to the electronic regulator using the circuit breaker or the protection fuse in the power supply circuit.

Connecting the power supply cable to the mains (220V-240V AC)

220 V~ - 240 V~ +10 % -10 % 50Hz Single phase power supply. Connect the power supply cable to the mains: - Neutral (N) = Blue wire – Live (L)= Brown wire – Earth(⊕) = Green and yellow wire (if the product is Class I).

The wires must be connected in an electrical connection box which complies with applicable standards.

Please NOTE: (as per the illustrations below) that the heating element must always be located at the bottom of the rail (eitherside). NEVER from the Top.

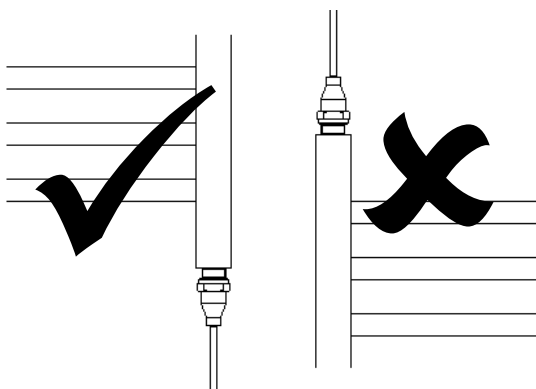

WARNINGS

Please read all these instructions carefully before using this device. Save these instructions for future use.

- Before use, please check that the supply voltage and that of the appliance are the same (see product rating label).
- Always switch off the electricity supply at the mains during cleaning and maintenance.
- Electrical safety is guaranteed only if the element is connected to a suitably earthed electricity supply, according to the regulations in force.
- In case of damage to the supply cord, switch off the device and do not tamper with it. Damaged supply cords can be rectified only and exclusively by the manufacturer or by an appointed representative. Failure to comply with the above may endanger the safety of the whole system.
- The wires must be connected in an electrical connection box which complies with applicable standards.
- The towel rail will get very HOT so is NOT suitable for use in locations where this could cause a hazard (e.g. where infirmed persons or young children will be present unsupervised).
- Fitted inside the heater are two separate protection devices to prevent over-heating of the rail. These are a thermostat and thermofuse.
- The element must be permanently connected to a suitable electricity supply by way of the cable provided. This should be via a fused spur in accordance with the IEE Wiring Regulations (BS7671). If sited in a bathroom, the Fused Connection Unit must be located out of reach of persons using the basin, shower or bath. If in doubt, consult a qualified electrician.

CARE AND MAINTENANCE

- Regular cleaning with a soft cloth will keep the surfaces of your towel warmer looking new.
- Soapy water can be used to remove stubborn stains and then buff dry with a soft cloth.
- Do not use abrasive or chemical cleaners to clean your towel warmer as these will damage the surface finish over time.

DISPOSAL



This appliance must be disposed of through the appropriate recollection centres to be recycled. In case of replacement it can be sent back to your distributor.

This handling of the product's end of life will allow us to preserve our environment and curb the consumption of natural resources. This symbol applied on the product, indicates the obligation to consign it to a special recollection centre to be disposed of in accordance with European Directive WEEE 2002/96/EC guideline. The manufacturer reserves the right to modify the product without previous notice for technical or construction improvements.